

RECOMMENDED P.C.B. LAYOUT

Z000003 LED TO BE CENTERED IN 3.0 MM WITHIN ±.25MM

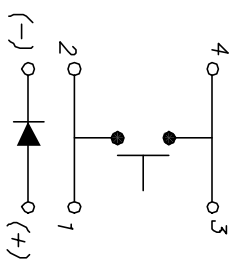

CIRCUIT: SPST
CONTACT CONFIGURATION

- NOTES:
1. ALL DIMENSIONS IN MM
 2. GENERAL TOLERANCE: X.X=±0.4
X.XX=±0.25
 3. RATING: 50mA, 12VDC
 4. TRAVEL: 0.25 +0.2/0.1mm
 5. OPERATING FORCE: 160±50gf
 6. CONTACT RESISTANCE: 100mΩ-Ωmax
 7. ▲ DENOTES CRITICAL PARAMETER.

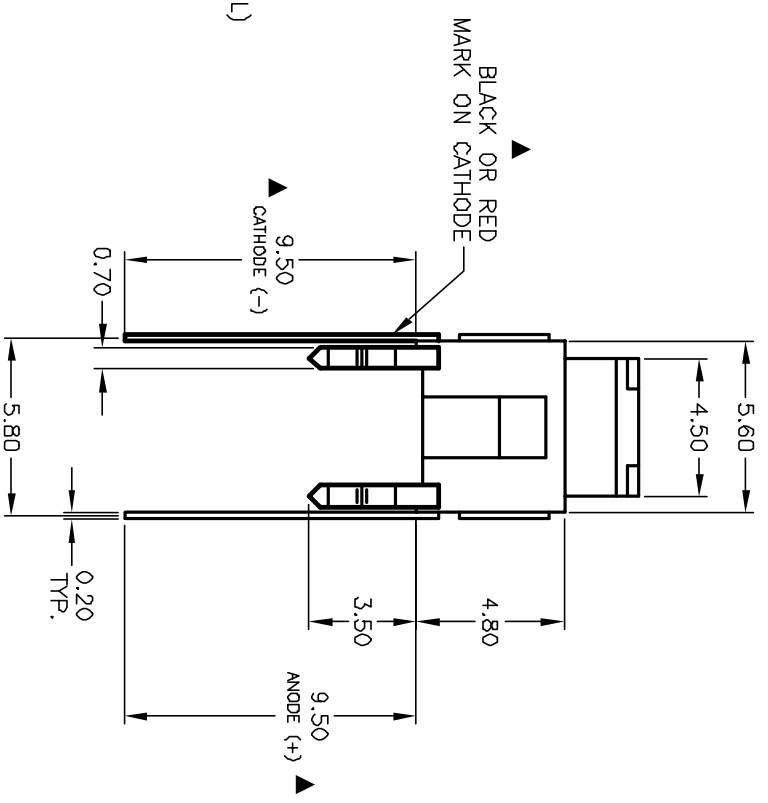
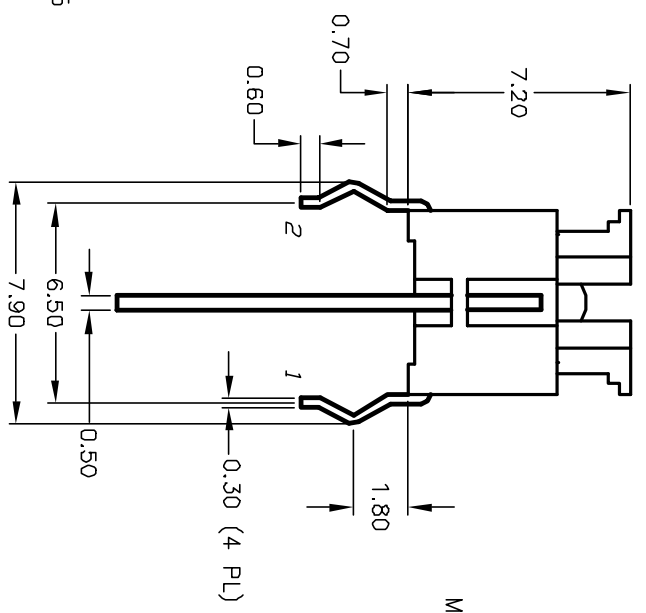

E-SWITCH®

B	13186	LED LOCATION AND P/N	6/5/03	AR	TITLE	SCALE	DATE	DR	DWG	REV
A	11481	RELEASED FOR PRODUCTION	8/6/01	CJB	TL1240 GRN (Super Bright LED)	4:1	8/6/01	CJB	P001084	B
REV.	ECN No.	DESCRIPTION	DATE	CHKD						
THE INFORMATION CONTAINED IN THIS DOCUMENT IS PROPRIETARY TO E-SWITCH AND IS NOT TO BE COPIED OR TRANSFERRED										